



MC.INF/15/11  
1 December 2011  
OSCE+  
ENGLISH only

Vilnius, 1 December 2011

**CIRCULAR NOTE No. 11**

Please find the electronic copy of the Delegates' Handbook annexed hereto. The printed version will be distributed in Vilnius.

Sponsors:



**OSCE**

LITHUANIA 2011 LIETUVA

**18<sup>th</sup> OSCE  
Ministerial Council  
Vilnius, 6 and 7 December 2011**



**OSCE**  
LITHUANIA 2011 LIETUVA

**18<sup>th</sup> OSCE  
Ministerial Council  
Vilnius, 6 and 7 December 2011**

**Delegates'  
Handbook**

# Programme

## Tuesday, 6 December 2011

- 9.20 Family photo
- 9.30 **Opening session (open)**  
- Formal opening and adoption of the agenda  
- Address by a representative of the host country  
- Address by the OSCE Chairperson-in-Office  
- Address by the President of the OSCE Parliamentary Assembly  
- Report by the OSCE Secretary General
- First plenary session (closed)**  
- Statements by heads of delegations
- 13.00 Working luncheon hosted by the Chairperson-in-Office
- Separate lunch for members of delegations
- 15.00-18.00  
**Second plenary session (closed)**  
- Statements by heads of delegations
- 19.30 Reception for members of delegations and the press
- 19.30 Official dinner for ministers for foreign affairs/heads of delegations

## Wednesday, 7 December 2011

- 9.30 **Third plenary session (closed)**  
- Statements by heads of delegations  
- Adoption of Ministerial Council decisions and documents  
- Any other business
- Closing session (open)**  
- Address by a representative of the host country  
- Formal closure (statements by the current and incoming Chairpersons-in-Office)
- 13.30 Press conference of the OSCE Troika ministers

## General Information

### Venue

The 18th OSCE Ministerial Council is held in Vilnius at the Lithuanian Exhibition and Congress Centre LITEXPO. The Centre is located approximately six kilometers (15 min) southwest of Vilnius city centre and the old town.

LITEXPO is the largest exhibition and convention centre in the Baltic States consisting of five exhibition halls, totaling 17.6 thousand sq meters. The centre is a unique site where the pulse of public life is best felt. LITEXPO is a joint stock company established by the Ministry of Economy of the Republic of Lithuania.

### *Lithuanian Exhibition and Congress Centre LITEXPO*

Laisvės pr. 5  
LT-04215 Vilnius  
[www.litexpo.lt/en](http://www.litexpo.lt/en)

### LITEXPO opening hours

The Delegation Area is open during the following hours:

Sunday	4	December	09.00-23.00
Monday	5	December	07.00-15.00
Tuesday	6	December	07.00-15.00
Wednesday	7	December	07.00-17.00

The Accreditation Desk is open during the following hours:

#### Delegations:

Saturday	3	December	12.00-20.00
Sunday	4	December	08.00-24.00
Monday	5	December	08.00-22.00
Tuesday	6	December	07.00-18.00
Wednesday	7	December	07.00-13.00

#### Media:

Tuesday	6	December	08.00-18.00
Wednesday	7	December	08.00-13.00

### Entrances

Heads of Delegation arriving by motorcade shall use the main Hall 3 entrance to LITEXPO. Other vehicles will not be allowed to enter LITEXPO area. Delegates arriving via other modes of transport shall use the Hall 5 main walking entrance. Please see map on page 39.

## **Accreditation**

The LITEXPO area can only be accessed with a valid accreditation badge. Delegates and media representatives may be requested to present a proof of identity (national passport or ID card) at any time. Pins and badges must be worn and visible at all times for entry to all venues of the Ministerial Council. Please note that lapel pins and nominative badges are strictly for personal use and cannot be exchanged. The accreditation desk is located in Media Centre, 1st floor foyer near main entrance.

Tel. 8 5 255 9392

Email: [registration@mc2011.it](mailto:registration@mc2011.it)

### **Lapel pin:**

Heads of Delegation

### **Green badge**

Delegations, International Organisations

### **Purple badge**

Non-governmental organisations

### **Blue badge**

Organizers, OSCE Conference Services; Security

### **Orange badge**

Drivers

### **Brown badge**

Staff

### **Yellow badge**

Press

### **Lost badges:**

Loss of a pin or badge should be reported immediately to a Liaison Officer. In order to get a new one, please visit the Accreditation Desk in Media Centre, 1st floor foyer.

### **Information/Bilateral meetings desks**

Two desks are reserved for the delegations. One is located in Hall 4 foyer and the other in Hall 5 foyer. Vilnius City information desk is located in Hall 3 foyer.

### **General information desk/IT Help Desk, Hall 5**

Tel. 852559508; 852559505; 852559509/8 5 255 9555

Email: [infodesk@mc2011.it](mailto:infodesk@mc2011.it) / [ithelpdesk@mc2011.it](mailto:ithelpdesk@mc2011.it)

Fax. 8 5 255 9556

**Bilateral meeting desk, Hall 4**

Tel. 8 5 255 9504

**Vilnius City information desk, Hall 3**

Locations and services (see maps on pages 40)

**Main Plenary Hall**

1st floor, Hall 3

**Prep Comm**

1st floor, Hall 4

**Delegation Area**

1st floor, Hall 5

**Delegation offices**

1st floor, Hall 5

**Bilateral meeting rooms**

2nd floor, gallery 3; 1st floor, Hall 4; 2nd floor, gallery 5.

Only to be used by the Heads of Delegation on 6 and 7 December

Booking at the bilateral meetings desk in Hall 4.  
Tel. 8 5 255 9504

**Documents distribution centre**

1st floor, Hall 4 foyer

Documents and other material will be delivered to the delegations' pigeonholes and sent to the delegates' email; the same information will be available also on the OSCE public website

[www.osce.org/event/mc\\_2011](http://www.osce.org/event/mc_2011)

and on the Ministerial Council website

[www.osce-ministerial2011.mfa.lt](http://www.osce-ministerial2011.mfa.lt)

Reservations of informal meeting rooms should be made via the documents distribution centre.

Tel. 8 5 255 9414

Mobile: +43 664 141 88 67 and +370 693 37389

Email: [elke.lidarik@osce.org](mailto:elke.lidarik@osce.org)

Prepared statements, background documentation, comments or other papers for circulation as well as advance copies for interpreters should be submitted for delivery via the documents distribution centre ([elke.lidarik@osce.org](mailto:elke.lidarik@osce.org))

**Media Centre**

Located in Hall 1, Media Centre offers rooms for individual interviews and a large area for informal talks. The final press conference will be held on 7 December in Media Centre Hall 1.1. There is also a media briefing room available for the heads of delegations. The advance

booking at the media information desk is required.

The working area will be open for the media from 6 December until 7 December.

**Working hours:**

Tuesday	6	December	08.00-20.00
Wednesday	7	December	08.00-20.00

**Media Info Desk**

Tel.: +370 693 51490

Email: [media@osce-ministerial2011.mfa.lt](mailto:media@osce-ministerial2011.mfa.lt)

**Accreditation and interviews - Andrius Visockis**

Tel.: +370 655 45927

Email: [andrius.visockis@urm.lt](mailto:andrius.visockis@urm.lt)

**Pools for bilateral meetings - Janina Barauskytė**

Tel.: +370 693 43187

Email: [media@osce-ministerial2011.mfa.lt](mailto:media@osce-ministerial2011.mfa.lt)

**Booking of the briefing room - Rūta Jazukevičiūtė**

Tel.: +370 693 42465

Email: [ruta.jazukeviciute@urm.lt](mailto:ruta.jazukeviciute@urm.lt)

**Information on media arrangements - Mindaugas Lašas**

Tel.: +370 640 47313

Email: [mindaugas.lasas@urm.lt](mailto:mindaugas.lasas@urm.lt)

**Spokesperson of Chairman-in-Office - Renata Lazdin**

Tel.: +370 640 68068

Email: [renata.lazdin@urm.lt](mailto:renata.lazdin@urm.lt)

**OSCE Press and Public Information Section**

Media Centre Hall 1

Email: [press@osce.org](mailto:press@osce.org)

**OSCE Spokesperson - Virginie Coulloudon**

Tel.: +370 693 15835

Email: [virginie.coulloudon@osce.org](mailto:virginie.coulloudon@osce.org)

**Deputy Spokesperson - Frane Maroevic**

Tel.: +370 693 40172

Email: [frane.maroevic@osce.org](mailto:frane.maroevic@osce.org)

**Webteam - Velimir Alič**

Tel.: +370 693 38557

Email: [velimir.alic@osce.org](mailto:velimir.alic@osce.org)

## **IT Helpdesk**

1st floor, Hall 5 foyer.

Open when the Delegation Area is open.

Service from December 2-4, 8 will be offered from 07.00 to 22.00; December 5-7 will be offered 24/7 at the Hall 5 foyer; assistance can be requested by phone on +370 5 255 9555.

## **WLAN**

Wireless Local Area Network is available in all areas except for bilateral rooms.

## **Telephones**

Phone calls can be made free of charge. Dial 9 and the actual number for domestic calls outside the venue. Calls inside LITEXPO area can be made dialing 3 last numbers.

For example: if the number is 8 5 2559300, you can make a call dialing 300.

## **Fax machines**

In the delegation area there are 10 public fax machines. Please see map of the delegation area on page 47 and the numbers of the fax machines on page 20.

## **Photocopiers**

There are photocopiers in the delegation area and at the information desk.

## **Prayer room**

Located on 1st floor, Hall 5

## **First aid**

1st floor, beside Hall 5

Tel. 8 5 255 9500

Please contact your Liaison Officer or the Information desk for further guidance.

## **Smoking area**

Smoking is only allowed in the smoking room which is located outside in front of Hall 3.

## **Cash point**

The cash point is located in Hall 5 foyer.



### **Lost property**

Please contact the Information desk in Hall 5

Tel. 8 5 255 9508; 8 5 255 9505; 8 5 255 9509

### **Coat racks**

There are coat racks in all delegation offices. In the main Hall 5 foyer there is a supervised cloakroom and there is a cloakroom in Hall 3 foyer.

## **Arrival and Departure**

Delegates will arrive and depart via Vilnius Airport. There is an OSCE Information desk in the arrival hall of Terminal B. The Airport is located 8 kilometers from LITEXPO and 7 kilometers from city center. A shuttle service will operate between LITEXPO, hotels and the airport. See timetable on page 31.

Passengers departing from the main terminal are advised to arrive at the airport at least one hour before scheduled departure. The Head of Delegation should arrive at the airport VIP lounge at least 30 minutes prior to the departure and will be escorted by a Protocol officer and the Liaison officer.

Heads of Delegation arriving by commercial flights are welcomed at the plane by a Protocol officer and delegates are welcomed by the Liaison officer in the arrivals area. The Head of Delegation is escorted to the VIP lounge or is transported by limo directly from the plane to the hotel with police escort. The rest of delegation will follow regular airport arrival procedures and will be transported by a minibus to the hotel/LITEXPO. Delegations arriving by special flight will be welcomed at the plane by the Director (Deputy Director) of State and Diplomatic Protocol and the Liaison officer. The motorcade will depart from the plane directly to the hotel or LITEXPO.

The Protocol Department of the Ministry for Foreign Affairs is responsible for all necessary arrangements at the VIP lounge.

Delegations are requested to mark their luggage with special OSCE tags (distributed via OSCE Conference Services). Upon arrival, the luggage is loaded into the delegation (s) motorcade. Upon departure by a special flight, the luggage can be transported to the airport and checked-in beforehand and upon departure by a commercial flight the luggage are loaded into the

motorcade and checked-in when arriving at the airport.

**Vilnius Airport:**

<http://www.vilnius-airport.lt/en/>

Email: [airport@vno.lt](mailto:airport@vno.lt)

Tel.: + 370 5 230 66 66, + 370 5 273 93 05.

**Ministry of Foreign Affairs**

State and Diplomatic Protocol Department

Irena Ūsaitė

Tel. +370 693 30986

Fax +370 5 236 2462

E-mail: [irena.usaite@urm.lt](mailto:irena.usaite@urm.lt)

Dovile Elvan

Tel. + 370 693 58537

Fax + 370 5 236 2462

E-mail: [dovile.elvan@urm.lt](mailto:dovile.elvan@urm.lt)

## Transportation

**Motorcades**

Each official delegation will be provided with **one chauffeur driven limousine** for the use of HoD and a chauffeur-driven **mini-van** (at least 8 seats) if the delegation consists of **more than three** delegation members (including the HoD). The limousine service will be available from the time of arrival (but not prior to 5 December) until departure.

Any further routes of the limousine and the minivan will be arranged and coordinated directly through the Liaison officers.

**Embassy car**

Embassy drivers should also be accredited and all cars should have OSCE permits.

**Public transportation**

Vilnius city public transport will be available free of charge with the OSCE badge on December 4th-8th. For more information about schedules of trolleybuses, buses, - please visit [www.vilniustransport.lt](http://www.vilniustransport.lt).

**Shuttle service**

The shuttles will circulate **the following routes:**

**-AIRPORT-HOTELS (from 3 to 6 DEC)**

**-HOTELS-AIRPORT (from 6 to 8 DEC)**

**-HOTELS-LITEXPO (from 4 to 7 DEC)**  
**-LITEXPO-HOTELS (from 4 to 7 DEC)**  
**-LITEXPO-NATIONALART GALLERY**  
**(6 DEC, PM service)**  
**-NATIONALART GALLERY-HOTELS**  
**(6 DEC, PM service)**

6-7 December the shuttle service will start operating HOTELS - LITEXPO route 2 hours prior to the first session and 2 hours after the last session.

For further information concerning transportation during the Ministerial Council, please contact your Liaison Officer or

Linus VERBUŠAITIS  
Transport co-ordinator  
Mob. +370 693 45728  
Tel. +370 5 236 2558  
E-mail: linas.verbusaitis@urm.lt

## Security

The Lithuanian Security Department is responsible for security at all venues indicated in the programme. Participants should be aware that the use of metal detectors and x-ray screening at the venues and the airport might cause some inconvenience.

For further information concerning security during the Ministerial Council, please contact:

### **Security**

Tel. +370 687 22301

## Delegation Liaison officer

Each delegation has a designated Liaison officer, who will be available from the arrival to the departure of the Head of Delegation. The Liaison officer can be reached by mobile phone. Please see contact details on page 13.

### **Liability**

The organisers are not liable for personal accidents or for the loss of or damage to the personal property of registered delegates. Delegates should make their own arrangements with respect to personal insurance.

## Meals

### Heads of Delegations

Thursday, 6 December 2011

**Working Lunch** at 13.00 at LITEXPO, PrepComm/PC Meeting Room

**Official Dinner** at 19.30 hosted by the CiO of the OSCE and Minister of Foreign Affairs A. Ažubalis.

### Delegates

Thursday, 6 December 2011

**Lunch** in the delegates' luncheon area in Hall 2, 4, 5 of LITEXPO at 13.00

**Reception** at 19.30 for the delegates and members of the press at LITEXPO and the National Art Gallery. Shuttle service operates between LITEXPO/hotels and the National Art Gallery. See timetable on page 33-34.

Two restaurants in Hall 5 and café in the Media Centre will be available on December 5-7th. Snacks will be offered on December 6,7th in the Delegation area.

## General information about Lithuania

### Population

3.2 million, 50.3 inhabitants per square kilometer.

### Area

65 200 square kilometers, i.e. 25 174 square miles.

### Capital

Vilnius. Population ca. 550.000.

### Government

Lithuania is a parliamentary republic with strong democratic traditions maintained since the restoration of independence on 11 March 1990. The President of the Republic is elected for a term of five years. Current President of Lithuania is Dalia Grybauskaitė, elected in 2009. The Lithuanian Parliament - Seimas - consists of 141 members, elected for a term of four years. Last parliamentary elections were held in 2008. Current speaker of Seimas is Irena Degutienė. The Government is formed by the Prime Minister - the post is currently occupied by Andrius Kubilius.

## **History**

Lithuanian lands initially inhabited by Baltic tribes were united in the early 13th century by Mindaugas, crowned as King of Lithuania in 1253. Around that time the state became known as The Grand Duchy of Lithuania. Later the Duchy expanded and incorporated large portions of Slavic lands. In 1569 The Polish-Lithuanian Commonwealth was created. It lasted for more than two centuries until 1795 when the partitions of the Commonwealth were carried out. As a result of the partitions, Lithuania was annexed to the Russian Empire. A Lithuanian national revival built the foundations of the modern Lithuanian nation and independent Lithuania, declared in 1918. In June 1940 in conformity with the Molotov-Ribbentrop pact, Lithuania was occupied and annexed by the Soviet Union. The occupation was followed by mass deportations to Siberia. The resistance movement, which lasted until the 1960s, was brought down. The late 1980s saw vital social and political changes, which allowed the establishment of Sąjūdis, an anti-communist independence movement. A democratically elected parliament proclaimed Lithuania's independence on 11 March 1990. After an effortful period of transition in the 1990s, Lithuania became a full member of NATO and the European Union in 2004 and a member of the Schengen Agreement on 21 December 2007.

## **Religion**

Roman Catholics 79%, Orthodox 4%, other religions 2%, non-denominational 10%.

## **Climate**

For weather visit [www.meteo.lt](http://www.meteo.lt)

## **Local time**

Central European Time zone (GMT + 2 hours).

## **Currency**

The Lithuanian currency is the litas (Lt, LTL), divided into 100 cents. For exchange rates, please visit [http://bank.lt/en\\_index.htm](http://bank.lt/en_index.htm). Cash payments are accepted only in litas, but most Lithuanian hotels, restaurants, department stores, etc. accept payments via credit cards (Visa, MasterCard, American Express).

## **Banks**

Banks are open Monday to Friday from 8.00 to 18.00 and from 10.00 to 15.00 on Saturdays (hours may vary depending on city district and/or the bank). In shopping centers banks are open Monday to Sunday from 10.00 to 22.00. Cash machines can be easily found in city center and shopping malls, most of them are available 24/7.

**Post offices**

Post offices are open from Monday through Friday from 9.00 to 19.00 with some variations. Stamps are sold at post offices and newsstands.

**Shops**

Shops are open from 10.00 to 18.00 on weekdays. Supermarkets and shopping malls are usually open from 8.00 to 22.00 or 23.00 seven days a week all year round.

**Smoking**

Smoking is prohibited on public transport, inside any public buildings including offices and restaurants, Smoking rooms or zones may be explicitly reserved for smokers.

**Electric appliance**

The voltage in Lithuania is 220V (50Hz). Plugs are of the two-pin continental European standard.

**Emergency telephone number**

Dial 112. Dial this number from all public telephone networks anywhere in Lithuania to report criminal offences, life-threatening conditions, health, safety or environmental hazards. Other emergency numbers can be obtained from the hotel reception.

**Medicines**

Medicines are sold only at pharmacies (in Lithuanian "vaistinė"). Some pharmacies have late opening hours.

**Useful websites**

Ministerial Council 2011  
[www.osce-ministerial2011.mfa.lt](http://www.osce-ministerial2011.mfa.lt)

Organization for Security and Co-operation in Europe  
[www.osce.org](http://www.osce.org)

Ministry of Foreign Affairs of Lithuania  
[www.urm.lt](http://www.urm.lt)

For further information on Lithuania and Vilnius:  
[www.travel.lt](http://www.travel.lt)  
[www.vilnius-tourism.lt](http://www.vilnius-tourism.lt)  
[www.vilnius-events.lt](http://www.vilnius-events.lt)  
[www.vilnius-convention.lt](http://www.vilnius-convention.lt)

Lithuanian Exhibition and Congress Centre LITEXPO  
[www.litexpo.lt](http://www.litexpo.lt)

Vilnius City Transport  
[www.vilniustransport.lt](http://www.vilniustransport.lt)

LRT, The Lithuanian Broadcasting Company  
[www.lrt.lt/english](http://www.lrt.lt/english)

### **Useful contact details**

#### **Hospitals**

Vilnius University Hospital SANTARISKIU KLINIKOS/ VŠĮ  
Vilniaus universiteto ligoninės Santariškių klinikos  
Santariškių g. 2 Vilnius  
Information: 8 5 236 5110, 8 5 236 5040;

Republican Vilnius University Hospital /VŠĮ Respublikinė  
Vilniaus universitetinė ligoninė  
Šiltnamių g. 29 Vilnius  
Information: 8 5 216 9140, 8 5 236 2056;

Centre Affiliate of Vilnius University Hospital/VŠĮ Vilniaus  
universiteto ligoninės Santariškių klinikų Centro filialas  
Žygimantų g. 3 Vilnius  
Information: 8 5 261 6258

#### **Gedimino Pharmacy**

Gedimino pr. 27, LT-2001 Vilnius  
Open 24/7

#### **Taxi**

+ 370 5 240 0004 / +370 5 210 1510

#### **VilniusMain Post Office**

Gedimino pr. 7, 01001 Vilnius  
Open 7.30-19.00 (Monday - Friday)  
9.00-16.00 (Saturday)

#### **Contact details**

Conference phone number is +370 5 255 9300  
In Lithuania, dial 8 5 255 9300

Lithuanian OSCE Chairmanship Task Force

Tel. 8 5 255 9484

Email: [Taskforce@mc2011.lt](mailto:Taskforce@mc2011.lt)

#### **Liaison Officers**

Albania	+370 693 01075
Germany	+370 693 09240
USA	+370 693 28192
Andorra	+370 693 02679
Armenia	+370 693 03349
Austria	+370 693 03994
Azerbaijan	+370 693 04304
Belarus	+370 693 04475
Belgium	+370 693 04790

Bosnia and Herzegovina	+370 693 04954
Bulgaria	+370 693 05101
Canada	+370 693 05784
Cyprus	+370 693 06327
Croatia	+370 693 06195
Denmark	+370 693 06992
Spain	+370 693 24265
Estonia	+370 693 07388
Finland	+370 693 07662
France	+370 693 08215
Georgia	+370 693 08869
United Kingdom	+370 693 09419
Greece	+370 693 10422
Hungary	+370 693 10593
Ireland	+370 693 11827
Iceland	+370 693 11057
Italy	+370 693 12689
Kazakhstan	+370 693 13402
Kyrgyzstan	+370 693 13538
Latvia	+370 673 21046
The Former Yugoslav Republic of Macedonia	+370 693 15470
Liechtenstein	+370 693 14680
Luxembourg	+370 693 15089
Malta	+370 693 16148
Moldova	+370 693 17072
Monaco	+370 693 17368
Montenegro	+370 693 18352
Norway	+370 693 19698
Uzbekistan	+370 693 28389
Netherlands	+370 693 19343
Poland	+370 693 20248
European Union	+370 693 04790
Portugal	+370 693 22061
Romania	+370 693 22405
Russian Federation	+370 693 22503
San Marino	+370 693 22687
The Holy See	+370 693 23035
Serbia	+370 693 23164
Slovakia	+370 693 23385
Slovenia	+370 693 23788
Sweden	+370 693 24503
Switzerland	+370 693 24921
Tajikistan	+370 693 25268
Czech Republic	+370 693 06524
Turkmenistan	+370 693 27091
Turkey	+370 693 25907
Ukraine	+370 693 27158



### **Partners for Co-operation**

Afghanistan	+370 693 00165
Australia	+370 693 03815
Japan	+370 693 12975
Mongolia	+370 693 17768
Republic of Korea	+370 693 23891
Thailand	+370 693 25546
Algeria	+370 693 01376
Egypt	+370 693 07196
Israel	+370 693 10971
Jordan	+370 693 11305
Morocco	+370 693 18842
Tunisia	+370 693 25624

### **International Organizations**

United Nations	+370 693 28540
United Nations High Commissioner for Refugees	+370 693 29042
European Commission	+370 693 29246
Council of Europe	+370 693 29523
NATO	+370 693 29603
OSCE Secretary General	+370 693 29708
ODIHR	+370 693 41671
High Commissioner for National Minorities	+370 693 41256
Representative on Freedom of Media	+370 693 40546
OSCE Parliamentary Assembly	+370 5 255 9406

### **Delegation offices**

#### **Fax numbers, public**

Fax 1: 852559454  
Fax 2: 852559455  
Fax 3: 852559456

Lithuania OSCE Chairmanship Task Force      Delegation offices No 24  
Tel. 8 5 255 9484  
Chairmanship@mc2011.lt

Albania      Delegation offices No 1  
Tel. 8 5 255 9461  
alb@mc2011.lt

Germany      Delegation offices No 2-4  
Tel. 852559462/463/464  
ger@mc2011.lt

United States of America

Delegation offices No 5-13  
Tel. 8 5 255 9465/466/467;  
Tel. 8 5 255 9469/470/471/472/473;  
Tel. 8 5 255 9468  
usa@mc2011.it

Andorra Delegation offices No 14  
Tel. 8 5 255 9474  
and@mc2011.it

Armenia Delegation offices No 15  
Tel. 8 5 255 9475  
arm@mc2011.it

Austria Delegation offices No 16  
Tel. 8 5 255 9476  
aut@mc2011.it

Azerbaijan Delegation offices No 17  
Tel. 8 5 255 9477  
aze@mc2011.it

Belarus Delegation offices No 18  
Tel. 8 5 255 9478  
blr@mc2011.it

Belgium Delegation offices No19  
Tel. 8 5 255 9479  
bel@mc2011.it

Bosnia and Herzegovina  
Delegation offices No20  
Tel. 8 5 255 9480  
bah@mc2011.it

Bulgaria Delegation offices No25  
Tel. 8 5 255 9485  
bul@mc2011.it

Canada Delegation offices No28  
Tel. 8 5 255 9488  
can@mc2011.it

Cyprus Delegation offices No34  
Tel. 8 5 255 9494  
cyp@mc2011.it

Croatia Delegation offices No35  
Tel. 8 5 255 9495  
cro@mc2011.it

Denmark	Delegation offices No36 Tel. 8 5 255 9496 dnk@mc2011.it
Spain	Delegation offices No37 Tel. 8 5 255 9497 esp@mc2011.it
Estonia	Delegation offices No38 Tel. 8 5 255 9498 est@mc2011.it
Finland	Delegation offices No39 Tel. 8 5 255 9499 fin@mc2011.it
France	Delegation offices No40, 41 Tel. 8 5 255 9520/521 fra@mc2011.it
Georgia	Delegation offices No42 Tel. 8 5 255 9522 geo@mc2011.it
United Kingdom	Delegation offices No43 Tel. 8 5 255 9523 gbr@mc2011.it
Greece	Delegation offices No44 Tel. 8 5 255 9524 grc@mc2011.it
Hungary	Delegation offices No45 Tel. 8 5 255 9525 hun@mc2011.it
Ireland	Delegation offices No46-48 Tel. 8 5 255 9527/528; 8 5 255 9526 ire@mc2011.it
Iceland	Delegation offices No49 Tel. 8 5 255 9529 ice@mc2011.it
Italy	Delegation offices No50 Tel. 8 5 255 9530 ita@mc2011.it
Kazakhstan	Delegation offices No51-53 Tel. 8 5 255 9531/532/533 kz@mc2011.it
Kyrgyzstan	Delegation offices No54 Tel. 8 5 255 9534 kyr@mc2011.it

Latvia	Delegation offices No55 Tel. 8 5 255 9535 lat@mc2011.it
the former Yugoslav Republic of Macedonia	Delegation offices No56 Tel. 8 5 255 9536 mkd@mc2011.it
Liechtenstein	Delegation offices No57 Tel. 8 5 255 9537 lie@mc2011.it
Lithuania	Delegation offices No21-24, 33 Tel. 8 5 255 9481/482/483/484; Tel. 8 5 255 9405 lit@mc2011.it
Luxembourg	Delegation offices No58 Tel. 8 5 255 9538 lux@mc2011.it
Malta	Delegation offices No59 Tel. 8 5 255 9539 mal@mc2011.it
Moldova	Delegation offices No60 Tel. 8 5 255 9540 mol@mc2011.it
Monaco	Delegation offices No61 Tel. 8 5 255 9541 mco@mc2011.it
Montenegro	Delegation offices No62 Tel. 8 5 255 9542 mon@mc2011.it
Norway	Delegation offices No63 Tel. 8 5 255 9543 nor@mc2011.it
Uzbekistan	Delegation offices No64 Tel. 8 5 255 9544 uzb@mc2011.it
Netherlands	Delegation offices No65 Tel. 8 5 255 9545 nl@mc2011.it

Poland/EU	Delegation offices No68-70 Tel. 8 5 255 9548/560; 8 5 255 9519 pol@mc2011.it
European Union	Delegation offices No71, 72; 69=meeting room Tel. 8 5 255 9561/562; 8 5 255 9519 eu@mc2011.it
Portugal	Delegation offices No66 Tel. 8 5 255 9546 por@mc2011.it
Romania	Delegation offices No67 Tel. 8 5 255 9547 rom@mc2011.it
Russian Federation	Delegation offices No73-76; 77=meeting room Tel. 8 5 255 9563/564/565/566; Tel. 8 5 255 9567 rus@mc2011.it
San Marino	Delegation offices No78 Tel. 8 5 255 9568 smr@mc2011.it
Holy See	Delegation offices No79 Tel. 8 5 255 9569 vat@mc2011.it
Serbia	Delegation offices No80 Tel. 8 5 255 9570 srb@mc2011.it
Slovakia	Delegation offices No81 Tel. 8 5 255 9571 svk@mc2011.it
Slovenia	Delegation offices No82 Tel. 8 5 255 9572 slo@mc2011.it
Sweden	Delegation offices No83 Tel. 8 5 255 9573 swe@mc2011.it
Switzerland	Delegation offices No84 Tel. 8 5 255 9574 ch@mc2011.it

Tajikistan Delegation offices No85  
Tel. 8 5 255 9575  
taj@mc2011.it

Czech Republic Delegation offices No86  
Tel. 8 5 255 9576  
cze@mc2011.it

Turkmenistan Delegation offices No87  
Tel. 8 5 255 9577  
tkm@mc2011.it

Turkey Delegation offices No88  
Tel. 8 5 255 9578  
tur@mc2011.it

Ukraine Delegation offices No89, 90  
Tel. 8 5 255 9579/580  
ukr@mc2011.it

**Mediterranean and Asian partners**

Afghanistan Delegation offices No91  
Tel. 8 5 255 9581  
afg@mc2011.it

Australia Delegation offices No92  
Tel. 8 5 255 9582  
australia@mc2011.it

Japan Delegation offices No93  
Tel. 8 5 255 9583  
jap@mc2011.it

Mongolia Delegation offices No94  
Tel. 8 5 255 9584  
mng@mc2011.it

Republic of Korea Delegation offices No95  
Tel. 8 5 255 9585  
kor@mc2011.it

Thailand Delegation offices No96  
Tel. 8 5 255 9586  
tha@mc2011.it

Algeria Delegation offices No97  
Tel. 8 5 255 9587  
alg@mc2011.it

Egypt Delegation offices No98  
Tel. 8 5 255 9588  
egy@mc2011.it

Israel Delegation offices No99  
Tel. 8 5 255 9589  
isr@mc2011.it

Jordan Delegation offices No100  
Tel. 8 5 255 9510  
jor@mc2011.it

Morocco Delegation offices No101  
Tel. 8 5 255 9511  
mor@mc2011.it

Tunisia Delegation offices No102  
Tel. 8 5 255 9512  
tun@mc2011.it

### **International Organizations**

United Nations Delegation offices No103  
Tel. 8 5 255 9513  
un@mc2011.it

United Nations High Commissioner for Refugees  
Delegation offices No104  
Tel. 8 5 255 9514  
unhcr@mc2011.it

Council of Europe Delegation offices No105  
Tel. 8 5 255 9515  
coe@mc2011.it

North Atlantic Treaty Organisation  
Delegation offices No106  
Tel. 8 5 255 9400  
nato@mc2011.it

Other International Organisations, IO  
Delegation offices No107, 108  
Tel. 8 5 255 9401/402

### **OSCE Secretariat**

OSCE Secretary General  
Tel. 8 5 255 9438  
sg@mc2011.it

Executive Management  
Tel. 8 5 255 9439/440/441

Meeting Room of the OSCE Secretary

General Legal Services  
Tel. 8 5 255 9442  
d-dmf@mc2011.it

Director, Conflict Prevention Centre  
Tel. 8 5 255 9443  
d-cpc@mc2011.it

Conflict Prevention Centre  
Tel. 8 5 255 9444  
cpc@mc2011.it

Office of the Co-ordinator of OSCE Economic and  
Environmental Activities  
Tel. 8 5 255 9445  
ocee@mc2011.it

Special Representative and Co-ordinator for Combating  
Trafficking in Human Beings  
Tel. 8 5 255 9446  
srcthb@mc2011.it

External Co-operation  
Tel. 8 5 255 9447

Strategic Police Matters Unit  
Tel. 8 5 255 9448/449

Action Against Terrorism Unit  
Tel. 8 5 255 9449

OSCE Secretariat Tel. 8 5 255 9450

### **OSCE Institutions**

Secretariat, OSCE Parliamentary Assembly  
Delegation offices No 117  
Tel. 8 5 255 9406  
sec-pa@mc2011.it

Secretary General, OSCE Parliamentary Assembly  
Delegation offices No 118  
Tel. 8 5 255 9407  
sg-pa@mc2011.it

President, OSCE Parliamentary Assembly  
Delegation offices No 119  
Tel. 8 5 255 9408  
pres-pa@mc2011.it

Office of the OSCE PA  
Delegation offices No 120 - 121  
Tel. 8 5 255 9590/591/592/593  
office-pa@mc2011.it

Director, ODIHR Delegation offices No 122  
Tel. 8 5 255 9409  
d-odihr@mc2011.it



Meeting Room OSCE Institutions  
Delegation offices No 123

Secretariat, ODIHR  
Delegation offices No 124  
odihr@mc2011.lt

Representative on Freedom of the Media  
Delegation offices No 125  
Tel. 8 5 255 9410  
fom@mc2011.lt

FoM Secretariat  
Delegation offices No 126  
Tel. 8 5 255 9411  
office-fom@mc2011.lt

High Commissioner on National Minorities  
Delegation offices No 127  
Tel. 8 5 255 9403  
hcnm@mc2011.lt

HCNM Secretariat  
Delegation offices No 128  
Tel. 8 5 255 9404  
office-hcnm@mc2011.lt

## Hotels

**NARUTIS**  
Pilies g. 24 Vilnius  
Tel. 370 5 212 2894  
www.narutis.com

**RAMADA**  
Subačiaus g. 2 Vilnius  
Tel. +370 5 255 3355  
www.ramadavilnius.lt

**RELAIS AND CHATEAUX  
STIKLIAI HOTEL**  
Gaono g. 7 Vilnius  
Tel. +370 5 264 9595  
www.stikliaihotel.lt

**AMBERTON HOTEL**  
L. Stuokos-Gucevičiaus g. 1  
Vilnius  
Tel. +370 5 210 7461  
www.ambertonhotels.com/  
vilnius

**ARTIS**  
Liejyklos g. 11/23 Vilnius  
Tel. +370 5 266 0366  
www.centrumhotels.com/  
en/hotel-artis-centrum-  
hotels-vilnius.php

**ATRIUM HOTEL**  
Pilies g. 10 Vilnius  
Tel. +370 5 210 7777  
www.atrium.lt

**BEST WESTERN VILNIUS**  
Konstitucijos pr. 14 Vilnius  
+370 5 273 9595  
www.vilniushotel.eu

**CONGRESS**  
Vilniaus g. 2/15 Vilnius  
Tel. +370 5 269 1919  
www.congress.lt

**CROWNE PLAZA**  
M. K. Čiurlionio g. 84 Vilnius  
Tel. +370 5 274 3400  
[www.cpvilnius.com](http://www.cpvilnius.com)

**EUROPARROYALE HOTEL**  
Aušros Vartų g. 6 Vilnius  
Tel. +370 5 266 0770  
[www.groupeuropa.com/europa\\_royale/vilnius\\_hotel/](http://www.groupeuropa.com/europa_royale/vilnius_hotel/)

**GROTTHUSS**  
Ligoninės g. 7 Vilnius  
Tel. +370 5 266 0322  
[www.grotthusshotel.com](http://www.grotthusshotel.com)

**HOLIDAY INN**  
Šeimyniškių g. 1 Vilnius  
Tel. +370 5 210 3000  
[www.holidayinnvilnius.lt](http://www.holidayinnvilnius.lt)

**NERINGA**  
Gedimino pr. 23 Vilnius  
Tel. +370 5 212 2288  
[www.neringahotel.com](http://www.neringahotel.com)

**NOVOTEL**  
Gedimino pr. 16 Vilnius  
Tel. 370 5 266 6200  
[www.novotel.com](http://www.novotel.com)

**RADISSON BLU LIETUVA**  
Konstitucijos pr. 20 Vilnius  
Tel. 370 5 272 6272  
[www.radissonblu.com/lietuvahotel-vilnius](http://www.radissonblu.com/lietuvahotel-vilnius)

**RATONDA**  
Gedimino pr. 52/1 Vilnius  
Tel. +370 5 212 0670  
[www.centrumhotels.com/en/hotel-ratonda-centrum-hotels-vilnius.php](http://www.centrumhotels.com/en/hotel-ratonda-centrum-hotels-vilnius.php)

**ŠARŪNAS**  
Raitininkų g. 4 Vilnius  
Tel. +370 5 272 4888  
[www.hotelsarunas.lt](http://www.hotelsarunas.lt)

**SHAKESPEARE**  
Bernardinų g. 8/8 Vilnius  
Tel. 370 5 266 5885  
[www.shakespeare.lt](http://www.shakespeare.lt)

**ALGIRDAS HOTEL**  
Algirdo g. 24 Vilnius  
Tel. +370 5 232 6650  
[www.argirdashotel.lt](http://www.argirdashotel.lt)

**CENTRO KUBAS**  
Stiklių g. 3 Vilnius  
Tel. +370 5 266 0860  
[www.hotel.centrokubas.lt](http://www.hotel.centrokubas.lt)

**GRATA HOTEL**  
Vytenio g. 9/25 Vilnius  
Tel. +370 5 268 3300  
[www.uniquestay.lt](http://www.uniquestay.lt)

**KAROLINA**  
Sausio 13-osios g. 2 Vilnius  
Tel. +370 5 216 8934  
[www.karolina.lt](http://www.karolina.lt)

**ECOTEL**  
Slucko g. 8 Vilnius  
Tel. +370 5 210 27 00  
[www.ecotel.lt](http://www.ecotel.lt)

# Shuttle Service Timetables

Litexpo - hotels - Litexpo

Bus no. 1	Litexpo - Congress - Holiday Inn - Litexpo			
From	Daily Departures Times			
	4/12	5/12	6/12	7/12
Litexpo	13:00	14:00	1:00	1:00
	14:30	17:00	3:00	3:00
	16:00	19:00	18:10	13:00
	19:00	21:00	20:10	14:00
	21:00	23:00	22:10	15:00
	22:00		23:10	16:00
				17:00
Congress	8:00	7:00	7:05	7:05
	9:00	8:00	7:35	7:35
	13:30	14:30	8:05	8:05
	15:00	17:30	18:40	13:30
	16:30	19:30	20:40	14:30
	19:30	21:30	22:40	15:30
	21:30	23:30	23:40	16:30
				17:30
Holiday Inn	8:05	7:05	7:10	7:10
	9:05	8:05	7:40	7:40
	13:35	14:35	8:10	8:10
	15:05	17:35	18:45	13:35
	16:35	19:35	20:45	14:35
	19:35	21:35	22:45	15:35
	21:35	23:35	23:45	16:35
				17:35
To Litexpo				

Bus no. 2	<b>Litexpo - Radisson Blu Lietuva - Best Western - Litexpo</b>			
From	<b>Daily Departures Times</b>			
	<b>4/12</b>	<b>5/12</b>	<b>6/12</b>	<b>7/12</b>
Litexpo	13:00	14:00	1:00	1:00
	14:30	17:00	3:00	3:00
	16:00	19:00	18:10	13:00
	19:00	21:00	20:10	14:00
	21:00	23:00	22:10	15:00
	22:00		23:10	16:00
				17:00
Radisson Blu Lietuva / Best Western	8:00	7:00	6:50	6:50
	9:00	8:00	7:10	7:10
	13:30	14:30	7:40	7:40
	15:00	17:30	8:10	8:10
	16:30	19:30	18:40	13:30
	19:30	21:30	20:40	14:30
	21:30	23:30	22:40	15:30
			23:40	16:30
			17:30	
To Litexpo				

Bus no. 3	Litexpo - Algirdo hotel - Crowne plaza - Litexpo			
From	Daily Departures Times			
	4/12	5/12	6/12	7/12
Litexpo	13:00	14:00	1:00	1:00
	14:30	17:00	3:00	3:00
	16:00	19:00	18:10	13:00
	19:00	21:00	20:10	14:00
	21:00	23:00	22:10	15:00
	22:00		23:10	16:00
				17:00
Algirdas hotel	8:00	7:00	6:50	6:50
	9:00	8:00	7:20	7:20
	13:30	14:20	7:50	7:50
	14:50	17:20	8:20	8:20
	16:20	19:20	18:30	13:20
	19:20	21:20	20:30	14:20
	21:20	23:20	22:30	15:20
			23:30	16:20
Crowne plaza	8:10	7:10	7:00	7:00
	9:10	8:10	7:30	7:30
	13:30	14:30	8:00	8:00
	15:00	17:30	8:30	8:30
	16:30	19:30	18:40	13:30
	19:30	21:30	20:40	14:30
	21:30	23:30	22:40	15:30
			23:40	16:30
			17:30	
To Litexpo				

Bus no. 4	<b>Litexpo - Radisson Blu Astoria / Ramada / EuropaRoyale - Grothuss - Litexpo</b>			
	<b>From</b>	<b>Daily Departures Times</b>		
	<b>4/12</b>	<b>5/12</b>	<b>6/12</b>	<b>7/12</b>
Litexpo	13:00	14:00	1:00	1:00
	14:30	17:00	3:00	3:00
	16:00	19:00	18:10	13:00
	19:00	21:00	20:10	14:00
	21:00	23:00	22:10	15:00
	22:00		23:10	16:00
				17:00
Radis- son Blu Astoria / Ramada / Europa Royale	8:00	7:00	6:45	6:45
	9:00	8:00	7:15	7:15
	13:30	14:30	7:35	7:35
	15:00	17:30	8:05	8:05
	16:30	19:30	18:35	13:25
	19:30	21:30	20:35	14:25
	21:30	23:30	22:35	15:25
			23:35	16:25
				17:25
Grothuss	8:05	7:05	6:50	6:50
	9:05	8:05	7:20	7:20
	13:25	14:25	7:40	7:40
	14:55	17:25	8:10	8:10
	16:25	19:25	18:40	13:30
	19:25	21:25	20:40	14:30
	21:25	23:25	22:40	15:30
			23:40	16:30
			17:30	
To Litexpo				

Bus no. 5	<b>Litexpo - Neringa - Novotel - Litexpo</b>			
From	<b>Daily Departures Times</b>			
	<b>4/12</b>	<b>5/12</b>	<b>6/12</b>	<b>7/12</b>
Litexpo	13:00	14:00	1:00	1:00
	14:30	17:00	3:00	3:00
	16:00	19:00	18:10	13:00
	19:00	21:00	20:10	14:00
	21:00	23:00	22:10	15:00
	22:00		23:10	16:00
				17:00
Neringa	8:00	7:00	6:35	6:35
	9:00	8:00	7:05	7:05
	13:25	14:25	7:35	7:35
	14:55	17:25	8:05	8:05
	16:25	19:25	18:40	13:25
	19:25	21:25	20:40	14:25
	21:25	23:25	22:40	15:25
			23:40	16:25
Novotel	8:05	7:05	6:40	6:40
	9:05	8:05	7:10	7:10
	13:30	14:30	7:40	7:40
	15:00	17:30	8:10	8:10
	16:30	19:30	18:45	13:30
	19:30	21:30	20:45	14:30
	21:30	23:30	22:45	15:30
			23:45	16:30
To Litexpo			17:30	

Bus no. 6	<b>Litexpo - Artis - Amberton - Litexpo</b>			
<b>From</b>	<b>Daily Departures Times</b>			
	<b>4/12</b>	<b>5/12</b>	<b>6/12</b>	<b>7/12</b>
<b>Litexpo</b>	13:00	14:00	1:00	1:00
	14:30	17:00	3:00	3:00
	16:00	19:00	18:10	13:00
	19:00	21:00	20:10	14:00
	21:00	23:00	22:10	15:00
	22:00		23:10	16:00
				17:00
<b>Artis hotel</b>	8:00	7:00	6:45	6:45
	9:00	8:00	7:15	7:15
	13:30	14:30	7:35	7:35
	15:00	17:30	8:05	8:05
	16:30	19:30	18:40	13:25
	19:30	21:30	20:40	14:25
	21:30	23:30	22:40	15:25
			23:40	16:25
				17:25
<b>Amberton</b>	8:05	7:05	6:50	6:50
	9:05	8:05	7:20	7:20
	13:35	14:35	7:40	7:40
	15:05	17:35	8:10	8:10
	16:35	19:35	18:45	13:30
	19:35	21:35	20:45	14:30
	21:35	23:35	22:45	15:30
			23:45	16:30
			17:30	
<b>To Litexpo</b>				



Bus no. 7	Litexpo - Shakespeare - Atrium / Narutis - Litexpo			
From	Daily Departures Times			
	4/12	5/12	6/12	7/12
Litexpo	13:00	14:00	1:00	1:00
	14:30	17:00	3:00	3:00
	16:00	19:00	18:10	13:00
	19:00	21:00	20:10	14:00
	21:00	23:00	22:10	15:00
	22:00		23:10	16:00
				17:00
Shakespeare	8:00	7:00	6:45	6:45
	9:00	8:00	7:15	7:15
	13:30	14:30	7:35	7:35
	15:00	17:30	8:05	8:05
	16:30	19:30	18:40	13:25
	19:30	21:30	20:40	14:25
	21:30	23:30	22:40	15:25
			23:40	16:25
Atrium / Narutis	8:05	7:05	6:50	6:50
	9:05	8:05	7:20	7:20
	13:35	14:35	7:40	7:40
	15:05	17:35	8:10	8:10
	16:35	19:35	18:45	13:30
	19:35	21:35	20:45	14:30
	21:35	23:35	22:45	15:30
			23:45	16:30
To Litexpo			17:30	

Bus no. 8	Litexpo - Stikliai - Centro - Litexpo			
From	Daily Departures Times			
	4/12	5/12	6/12	7/12
Litexpo	13:00	14:00	1:00	1:00
	14:30	17:00	3:00	3:00
	16:00	19:00	18:10	13:00
	19:00	21:00	20:10	14:00
	21:00	23:00	22:10	15:00
	22:00		23:10	16:00
				17:00
Stikliai / Centro	8:00	7:00	7:10	7:10
	9:00	8:00	7:40	7:40
	13:30	14:30	8:10	8:10
	15:00	17:30	18:40	13:30
	16:30	19:30	20:40	14:30
	19:30	21:30	22:40	15:30
	21:30	23:30	23:40	16:30
				17:30
To Litexpo				

## Shuttle Service

Litexpo - National Gallery of Art

Bus no. 1, 2, 3, 4, 5, 6, 7, 8	Litexpo - National Gallery of Art	
From	Daily Departures Times	
	6/12	
Litexpo	19:00	

## Shuttle Service

National Gallery of Art - Hotels

Bus no. 1	National Gallery of Art - Congress - Holiday Inn	
From	Daily Departures Times	
	6/12	
National Gallery of Art	21:00	

Bus no. 2	<b>National Gallery of Art - Radisson Blu Lietuva- Best Western</b>	
<b>From</b>		<b>Daily Departures Times</b>
	<b>6/12</b>	
National Gallery of Art	21:00	

Bus no. 3	<b>National Gallery of Art - Algirdo hotel - Crowne plaza</b>	
<b>From</b>		<b>Daily Departures Times</b>
	<b>6/12</b>	
National Gallery of Art	21:00	

Bus no. 4	<b>National Gallery of Art - Radisson Blu Astoria / Ramada / Europa- Royale - Grothuss</b>	
<b>From</b>		<b>Daily Departures Times</b>
	<b>6/12</b>	
National Gallery of Art	21:00	

Bus no. 5	<b>National Gallery of Art - Neringa - Novotel</b>	
<b>From</b>		<b>Daily Departures Times</b>
	<b>6/12</b>	
National Gallery of Art	21:00	

Bus no. 6	<b>National Gallery of Art - Artis - Amberton</b>	
<b>From</b>		<b>Daily Departures Times</b>
	<b>6/12</b>	
National Gallery of Art	21:00	

Bus no. 7	<b>National Gallery of Art - Shekspyras - Atrium / Narutis</b>	
From		<b>Daily Departures Times</b>
	<b>6/12</b>	
National Gallery of Art	21:00	

Bus no. 8	<b>National Gallery of Art - Stikliai - Centro</b>	
From		<b>Daily Departures Times</b>
	<b>6/12</b>	
National Gallery of Art	21:00	

## Shuttle Service

### Hotels - Airport

<b>Airport Bus no. 1</b>	<b>Congress - Holiday Inn - Airport</b>	
From		<b>Daily Departures Times</b>
	<b>7/12</b>	
Congress	13:00	
	14:00	
	15:00	
	16:00	
	17:00	
Holiday Inn	13:05	
	14:05	
	15:05	
	16:05	
	17:05	

<b>Airport Bus no. 2</b>	<b>Radisson Blu Lietuva - Best Western- Airport</b>	
<b>From</b>		<b>Daily Departures Times</b>
		<b>7/12</b>
Radisson Blu Lietuva		13:00
		14:00
		15:00
		16:00
		17:00

<b>Airport Bus no. 3</b>	<b>Algirdo hotel - Crowne plaza - Airport</b>	
<b>From</b>		<b>Daily Departures Times</b>
		<b>7/12</b>
Algirdas hotel		13:00
		14:00
		15:00
		16:00
		17:00
Crowne plaza		13:10
		14:10
		15:10
		16:10
		17:10

<b>Airport Bus no. 4</b>	<b>Radisson Blu Astoria / Ramada / EuropaRoyale - Grothuss - Airport</b>	
<b>From</b>		<b>Daily Departures Times</b>
	<b>7/12</b>	
<b>Grothuss</b>		13:00
		14:00
		15:00
		16:00
		17:00
<b>Radisson Blu Astoria / Ramada / Europa Royale</b>		13:05
		14:05
		15:05
		16:05
		17:05

<b>Airport Bus no. 5</b>	<b>Neringa - Novotel - Airport</b>	
<b>From</b>		<b>Daily Departures Times</b>
	<b>7/12</b>	
<b>Neringa</b>		13:00
		14:00
		15:00
		16:00
		17:00
<b>Novotel</b>		13:05
		14:05
		15:05
		16:05
		17:05

<b>Airport Bus no. 6</b>		<b>Artis - Amberton - Airport</b>	
<b>From</b>		<b>Daily Departures Times</b>	
		<b>7/12</b>	
<b>Artis hotel</b>		13:00	
		14:00	
		15:00	
		16:00	
		17:00	
<b>Amberton</b>		13:05	
		14:05	
		15:05	
		16:05	
		17:05	

<b>Airport Bus no. 7</b>		<b>Shekspyras - Atrium / Narutis</b>	
<b>From</b>		<b>Daily Departures Times</b>	
		<b>7/12</b>	
<b>Shekspyras</b>		13:00	
		14:00	
		15:00	
		16:00	
		17:00	
<b>Atrium / Narutis</b>		13:05	
		14:05	
		15:05	
		16:05	
		17:05	

Airport Bus no. 8	Stikliai - Centro - Airport	
From		Daily Departures Times
		7/12
Stikliai / Centro		13:00
		14:00
		15:00
		16:00
		17:00

## Maps

Overview of the Lithuanian Exhibition and Congress Centre LITEXPO

Map 1

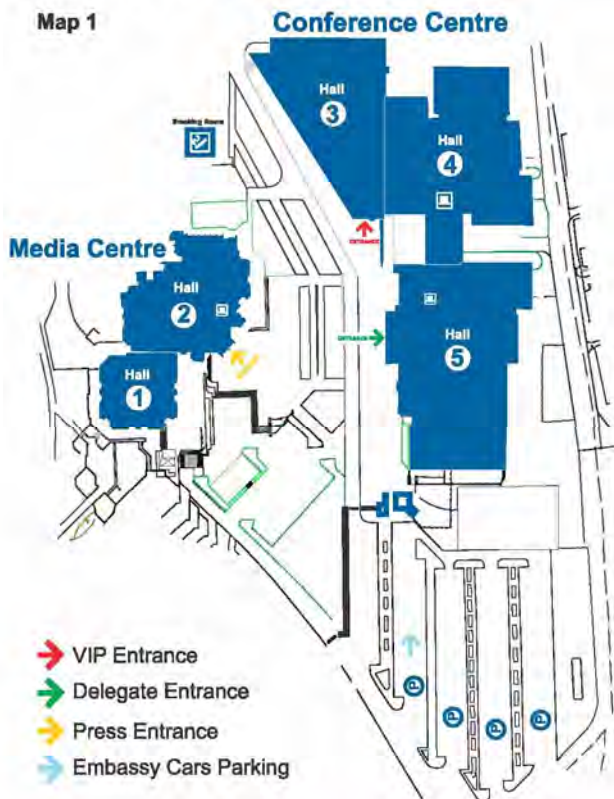



# Media Centre

## Map 2

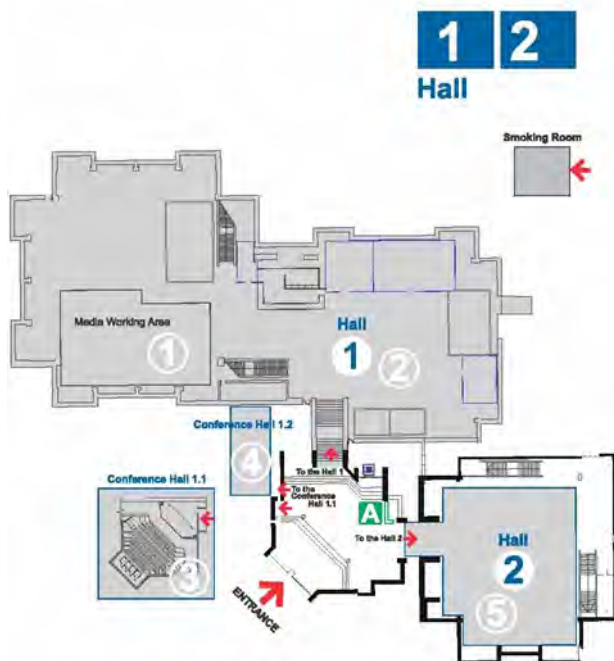

- ① Media working area
- ② Media Information desk, Media IT, OSCE PPIS offices
- ③ Press Conference Room
- ④ Briefing Room
- ⑤ Delegation Luncheon Area
- A** Accreditation desk

# Congress area

Map 3

## 3 Hall



- ① Ministerial Council Plenary Hall
- ② Bilateral Meetings

- i** General Information Desk
- ☐** Cafeteria
- Prayer's Room
- +** Medical Care
- ☐** Cloakroom
- WC** WC
- IT** IT Service
- T** Vilnius City information desk



# Congress area

Map 4

4

Hall



### In the Hall 5

- Bilateral Rooms Information desk
- Cafeteria
- Prayer's Room
- Medical Care
- Cloakroom
- WC
- IT Service
- Vilnius City information desk
- Accreditation Desk/ Hall 1

To Bilateral Meetings 1-4



# Congress area

Map 5

5

Hall

## OSCE Institutions

- 117 Secretariat, OSCE Parliamentary Assembly
- 118 Secretary General, OSCE Parliamentary Assembly
- 119 President, OSCE Parliamentary Assembly
- 120 Office of the OSCE PA
- 121 Meeting Room PA
- 122 Director, ODIHR
- 124 Secretariat, ODIHR
- 123 Meeting Room OSCE Institutions
- 125 Representative on Freedom of the Media
- 126 FOM Secretariat
- 127 High Commissioner on National Minorities
- 128 HCMN Secretariat



## OSCE Secretariat's Offices

- 1 OSCE Secretary General
- 2 Executive Management
- 3 Meeting Room SG
- 4 Executive Management
- 5 Executive Management
- 6 Legal Services
- 7 Director, CPC
- 8 CPC
- 9 OCEEA
- 10 SRCTHB
- 11 External Co-operation
- 12 SPMU
- 13 ATU
- 14 OSCE Secretariat

2<sup>nd</sup> Floor

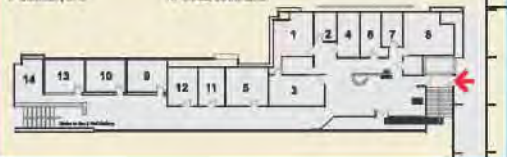

- General Information Desk
- Cafeteria
- Prayer's Room
- Medical Care
- Fax
- Cloakroom
- WC
- IT Service
- Vilnius City information desk



## Delegations Areas

1	Albania
2-4	Germany
5-13	USA
14	Andorra
15	Armenia
16	Austria
17	Azerbaijan
18	Belarus
19	Belgium
20	Bosnia and Herzegovina
21-24,33	Lithuania
25	Bulgaria
28	Canada
34	Cyprus
35	Croatia
36	Denmark
37	Spain
38	Estonia
39	Finland
40,41	France
42	Georgia
43	United Kingdom
44	Greece
45	Hungary
46,47	Ireland
48	Ireland
49	Iceland
50	Italy
51-53	Kazakhstan
55	Latvia
56	the former Yugoslav Republic of Macedonia
57	Liechtenstein
58	Luxembourg
59	Malta
60	Moldova
61	Monaco
62	Montenegro
63	Norway
64	Uzbekistan
65	Netherlands
68-70	Poland
71-72	European Union
65	Portugal
67	Romania
73-77	Russian Federation
78	San Marino
79	Holy See
80	Serbia
81	Slovakia
82	Slovenia
83	Sweden
84	Switzerland
85	Tajikistan
86	Czech Republic
87	Turkmenistan
88	Turkey
89-90	Ukraine
27-28	Personal Representatives of the CIO
29-30	OSCE Missions and Field Activities
31-32	Personal Representatives of the OSCE Chairman-In Office on the Conflict Deal with by the OSCE Minsk Conference

## Mediterranean and Asian Partners

91	Afghanistan	97	Algeria
92	Australia	98	Egypt
93	Japan	99	Israel
94	Mongolia	100	Jordan
95	Republic of Korea	101	Morocco
96	Thailand	102	Tunisia

## International Organizations

103	United Nations/ UN
104	United Nations High Commissioner for Refugees UNHCR
105	Council of Europe/ CoE
106	North Atlantic Treaty Organization/ NATO
107	International Organizations
108	International Organizations

